

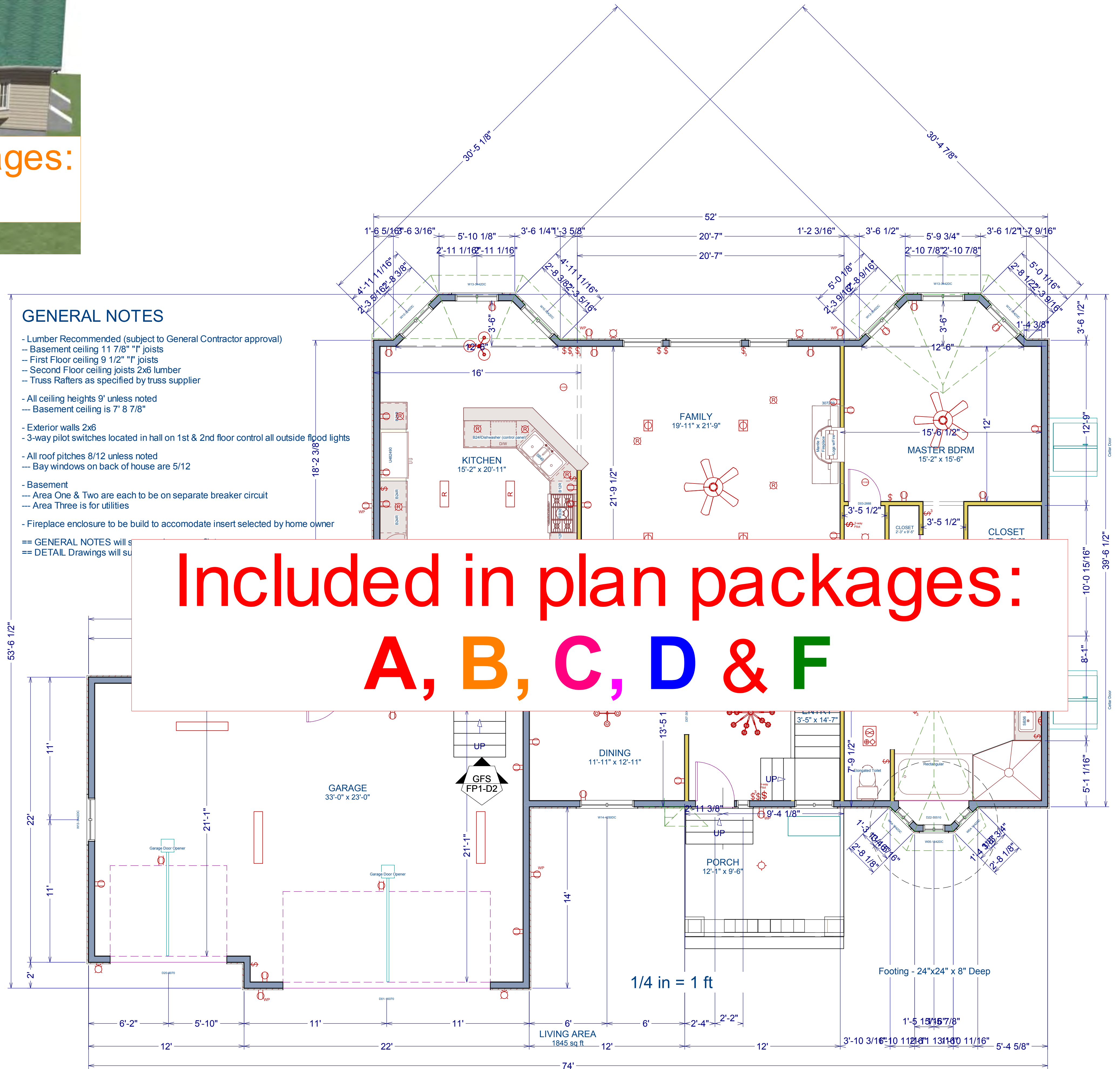

Included in plan packages:
B, C, D & F

GENERAL NOTES

- Lumber Recommended (subject to General Contractor approval)
- Basement ceiling 11 7/8" "I" joists
- First Floor ceiling 9 1/2" "I" joists
- Second Floor ceiling joists 2x6 lumber
- Truss Rafters as specified by truss supplier
- All ceiling heights 9' unless noted
- Basement ceiling is 7' 8 7/8"
- Exterior walls 2x6
- 3-way pilot switches located in hall on 1st & 2nd floor control all outside flood lights
- All roof pitches 8/12 unless noted
- Bay windows on back of house are 5/12
- Basement
 - Area One & Two are each to be on separate breaker circuit
 - Area Three is for utilities
- Fireplace enclosure to be build to accomodate insert selected by home owner
- == GENERAL NOTES will s
- == DETAIL Drawings will su



Included in plan packages:
A, B, C, D & F

IMPORTANT! To the best of my knowledge these plans are drawn to comply with owner's and/or builder's specifications. The CONTRACTOR shall verify all dimensions and attached drawings, and shall determine and/or verify any structural components (i.e. grade beams, piers, support beams, lumber spans, etc.) that are necessary. BILL LYON ENTERPRISES is not liable for errors once construction has begun. While every effort has been made in the preparation of this plan to avoid mistakes, the maker can not guarantee against human error. Also, **LIVING AREA** calculations do NOT include Closets, Stairs, Porch, Deck, and Balcony areas.

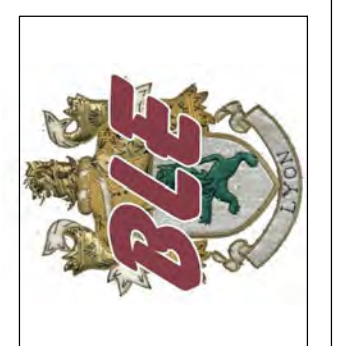

NO.	DESCRIPTION	BY	DATE

SHEET TITLE:
**Floorplan
Floor 1**

**Annis 24x36
pricing example**

DRAWINGS PROVIDED BY:
Bill Lyon Enterprises
- blyon@billyon.com
1385 HWY 305 N
Olive Branch, MS 38654
Phone: 662-893-3395 - Fax: 901-328-4747

Call Out Pg:
FP1
5/16/2011
Dwgs 1/4" = 1'
Details NTS
ARCH D (24" x 36")
SHEET #:
1 of 14

DOOR SCHEDULE							
NUMBER	LABEL	QTY	FLOOR	SIZE	DESCRIPTION	THICKNESS	COMMENTS
D01	16070	1	1	16070 R	GARAGE GARAGE DOOR P04	1 3/4"	
D02	2068	1	1	2068 L	2 DR. BIFOLD DOOR P04	1 3/8"	
D03	2668	2	1	2668 L IN	HINGED DOOR P04	1 3/8"	
D04	2668	1	1	2668 R IN	HINGED DOOR P04	1 3/8"	
D05	2668	1	2	2668 L	2 DR. BIFOLD	1 3/8"	
D06	2668	2	2	2668 R IN	HINGED DOOR P04	1 3/8"	
D07	3068	3	1	3068	DOORWAY		
D08	2868	1	1	2868 R IN	HINGED DOOR P04	1 3/8"	
D09	2868	1	2	2868 R IN	HINGED DOOR P04	1 3/8"	
D10	3068	1	1	3068 L EX	EXT. HINGED DOOR E21	1 3/4"	
D11	3068	1	1	3068 L EX	EXT. HINGED DOOR L02	1 3/4"	
D12	3068	1	1	3068 R EX	EXT. HINGED DOOR E21	1 3/4"	
D13	3068	1	2	3068 L EX	EXT. HINGED-GLASS	1 3/4"	
D14	3068	1	2	3068 R EX	EXT. HINGED DOOR P04	1 3/4"	
D15	3068	1	2	3068 R EX	EXT. HINGED-GLASS	1 3/4"	
D16	5068	1	1	5068 L IN	SLIDER	1 3/8"	
D17	5068	1	2	5068 L IN	SLIDER DOOR P04	1 3/8"	
D18	5068	1	2	5068 R IN	SLIDER DOOR P04	1 3/8"	
D19							
D20							
D21							
D22							

Included in plan packages:
C, D & F

WINDOW SCHEDULE							
NUMBER	LABEL	QTY	FLOOR	SIZE	EGRESS	DESCRIPTION	COMMENTS
W01		2	1	3120FX		FIXED GLASS - PINE	
W02		1	1	5720FX		FIXED GLASS - PINE	
W03	1068FX	1	1	1068FX		FIXED GLASS	
W04	1642DC	2	1	1642DC		DBL CASEMENT-LHL/RHR	
W05	1842DC	1	1	1842DC		DBL CASEMENT-LHL/RHR	
W06	2828DC	1	1	2828DC		DBL CASEMENT-LHL/RHR	
W07	2830DC	1	0	2830DC	YES	DBL CASEMENT-LHL/RHR	
W08	2930DC	1	0	2930DC	YES	DBL CASEMENT-LHL/RHR	
W09	3040DC	1	1	3040DC		DBL CASEMENT-LHL/RHR	
W10	3242DC	2	1	3242DC		DBL CASEMENT-LHL/RHR	
W12	3342DC	2	1	3342DC		DBL CASEMENT-LHL/RHR	
W13	3442DC	3	1	3442DC		DBL CASEMENT-LHL/RHR	
W14	4250DC	1	1	4250DC		DBL CASEMENT-LHL/RHR	
W15	4842DC	2	2	4842DC		DBL CASEMENT-LHL/RHR	
W16	4842DC	1	2	4842DC	YES	DBL CASEMENT-LHL/RHR	

Included in plan packages:
B, C, D & F

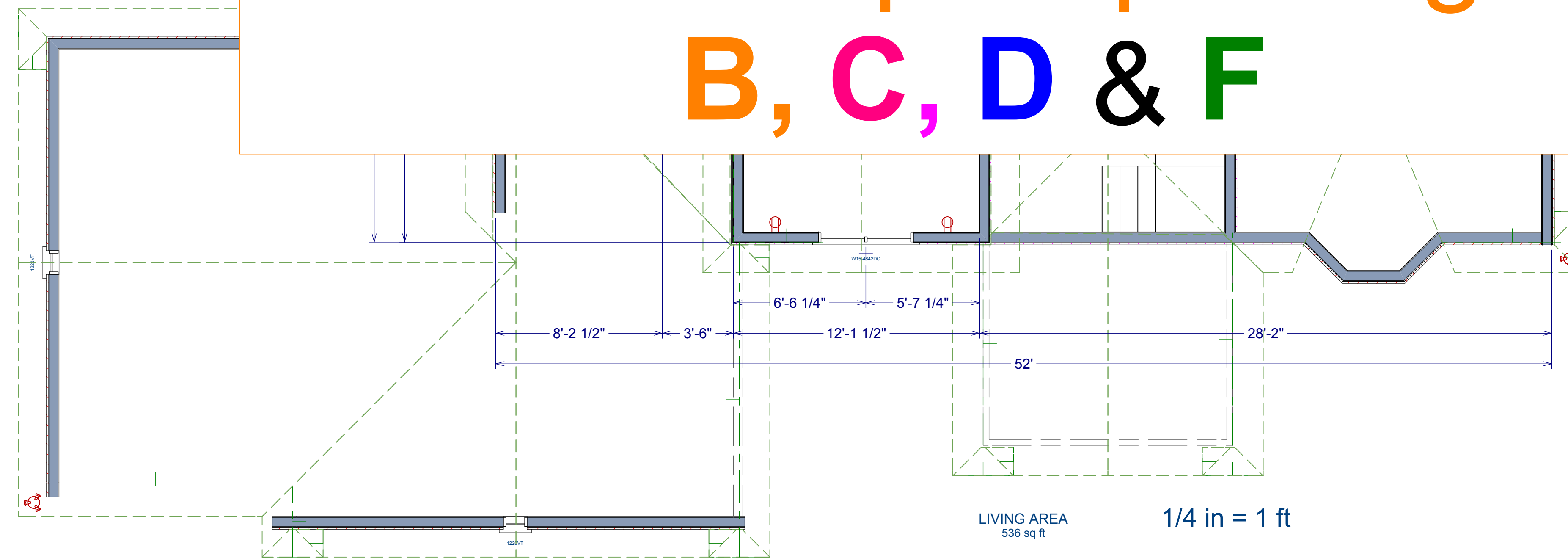
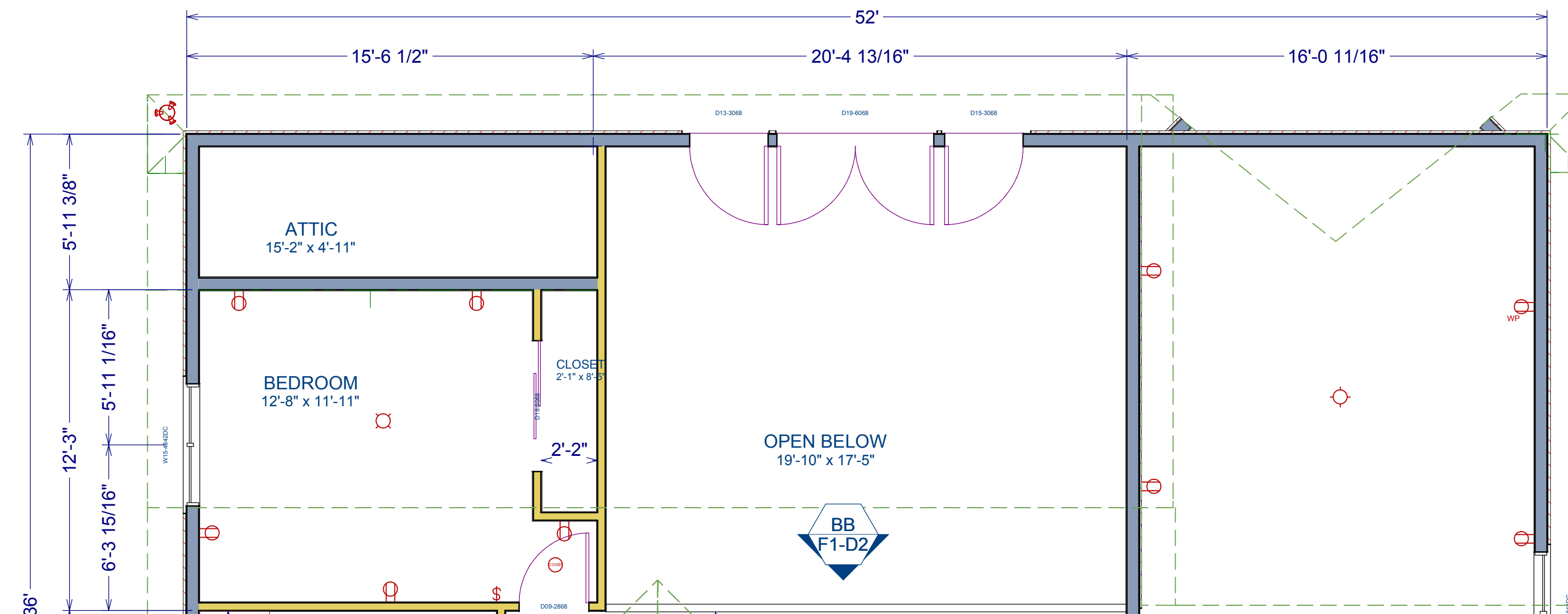

IMPORTANT: To the best of my knowledge these plans are drawn to comply with owner's and/or builder's specifications. The CONTRACTOR shall verify all dimensions and attached drawings, and shall determine and/or verify any structural components (i.e. grade beams, piers, support beams, lumber spans, etc.) that are necessary. BILL LYON ENTERPRISES is not liable for errors once construction has begun. While every effort has been made in the preparation of this plan to avoid mistakes, the maker can not guarantee against human error. Also, LIVING AREA calculations do NOT include Closets, Stairs, Corridors, Balcony, and Balcony areas.



NO.	DESCRIPTION	BY	DATE

SHEET TITLE:
**Floorplan
Floor 2**

**Annis 24x36
pricing example**

DRAWINGS PROVIDED BY:
Bill Lyon Enterprises
- blyon@billyon.com
1385 HWY 305 N
Olive Branch, MS 38654
Phone: 662-893-3395 - Fax: 901-328-4747

Call Out Pg:

FP2

5/16/2011

Dwgs 1/4" = 1'
Details NTS

ARCH D (24" x 36")

SHEET #:

2 of 14

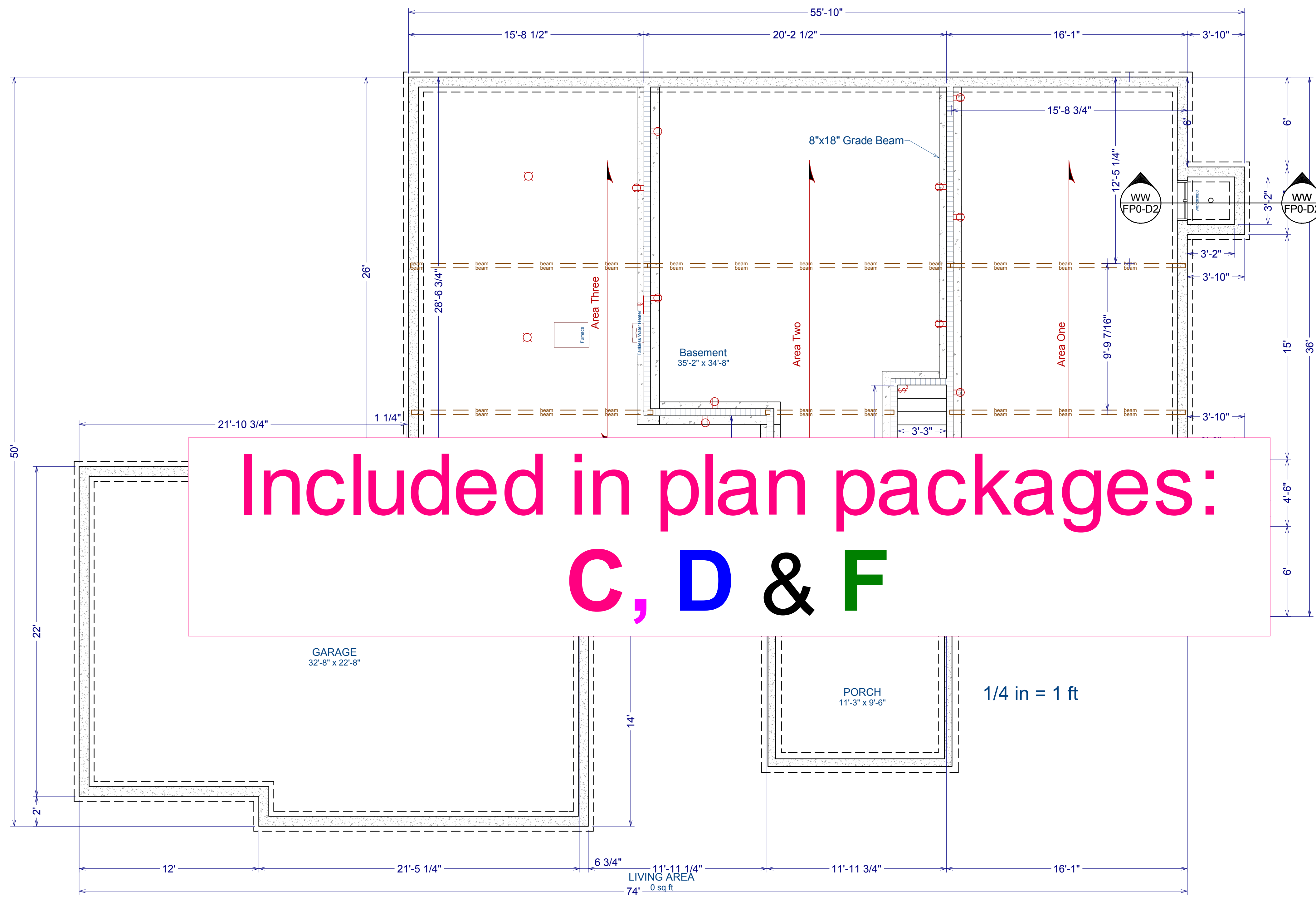

Included in plan packages:
C, D & F

IMPORTANT: To the best of my knowledge these plans are drawn to comply with owner's and/or builder's specifications. The CONTRACTOR shall verify all dimensions and attached drawings, and shall determine and/or verify any structural components (i.e. grade beams, piers, support beams, lumber spans, etc.) that are necessary. BILL LYON ENTERPRISES is not liable for errors once construction has begun. While every effort has been made in the preparation of this plan to avoid mistakes, the maker can not guarantee against human error. Also, **LIVING AREA** calculations do NOT include **Garage**, **Carport**, **Stair**, **Deck**, **Pool**, **Deck**, and **Backyard** areas.

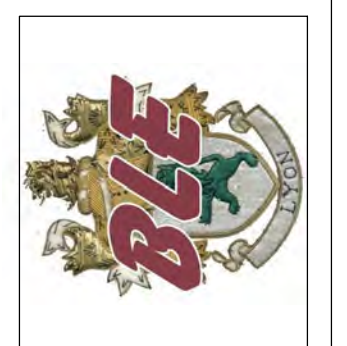

NO.	DESCRIPTION	BY	DATE

SHEET TITLE:
**Floorplan
Basement**

Annis 24x36
pricing example

DRAWINGS PROVIDED BY:
Bill Lyon Enterprises
- blyon@billyon.com
1385 HWY 305 N
Olive Branch, MS 38654
Phone: 662-893-3395 - Fax: 901-328-4747

Call Out Pg:

FPO

5/16/2011

Dwgs 1/4" = 1'
Details NTS

ARCH D (24" x 36")
SHEET #:

3 of 14

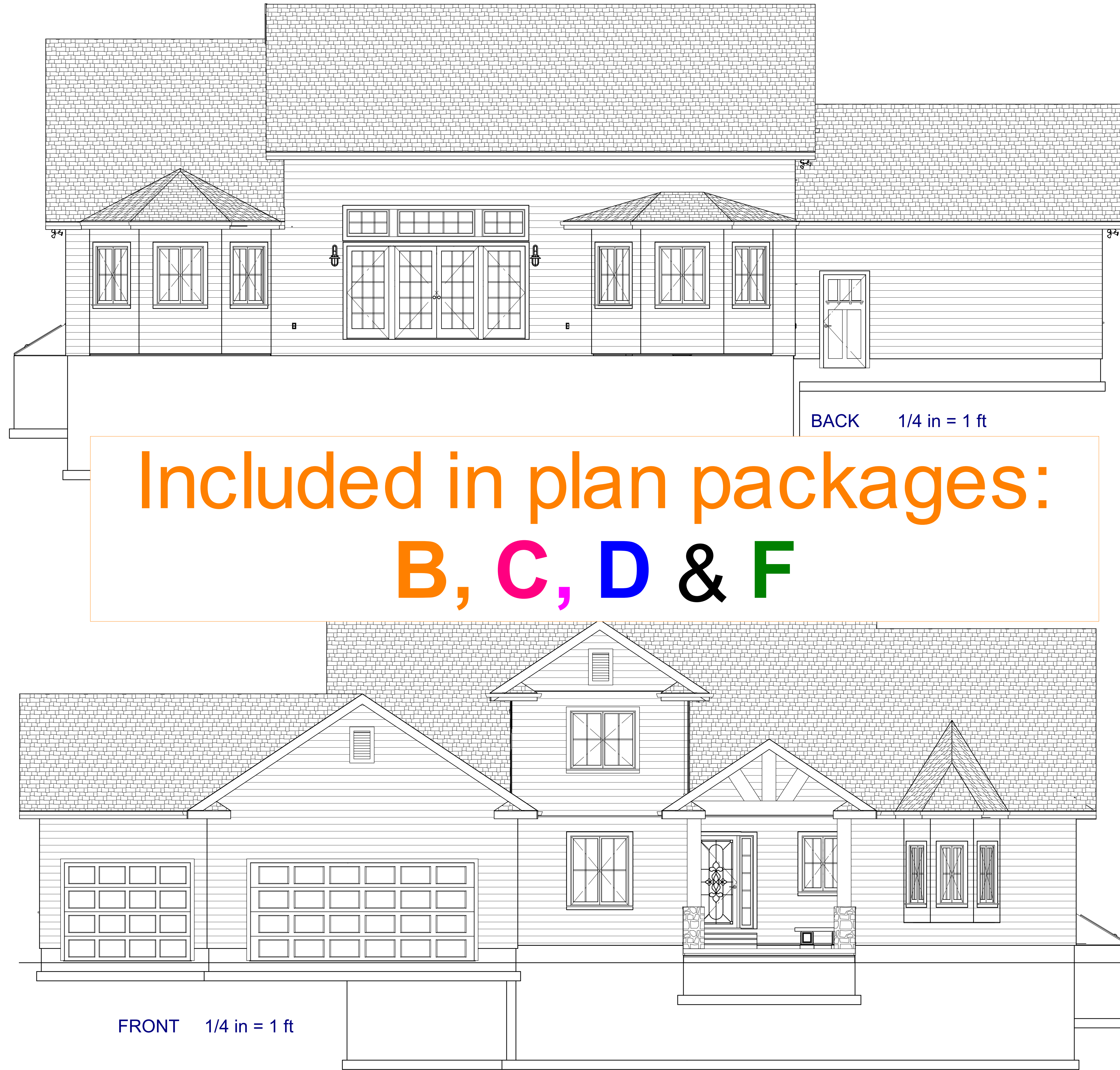

Included in plan packages:
B, C, D & F

IMPORTANT: To the best of my knowledge these plans are drawn to comply with owner's and/or builder's specifications. The CONTRACTOR shall verify all dimensions and attached drawings, and shall determine and/or verify any structural components (i.e. grade beams, piers, support beams, lumber spans, etc.) that are necessary. BILL LYON ENTERPRISES is not liable for errors once construction has begun. While every effort has been made in the preparation of this plan to avoid mistakes, the maker can not guarantee against human error. Also, **LIVING AREAS** calculations do NOT include **Garage, Storage (Carport), Stair, Entry, Hall, Closets, Bath, and Balcony** areas.



NO.	DESCRIPTION	BY	DATE

SHEET TITLE:
Elevations 1

Annis 24x36
 pricing example

DRAWINGS PROVIDED BY:
Bill Lyon Enterprises
 - blyon@billyon.com
 1385 HWY 305 N
 Olive Branch, MS 38654
 Phone: 662-893-3395 - Fax: 901-328-4747

Call Out Pg:

5/16/2011
 Dwgs 1/4" = 1'
 Details NTS

ARCH D (24" x 36")
 SHEET #:

4 of **14**



Included in plan packages:
B, C, D & F

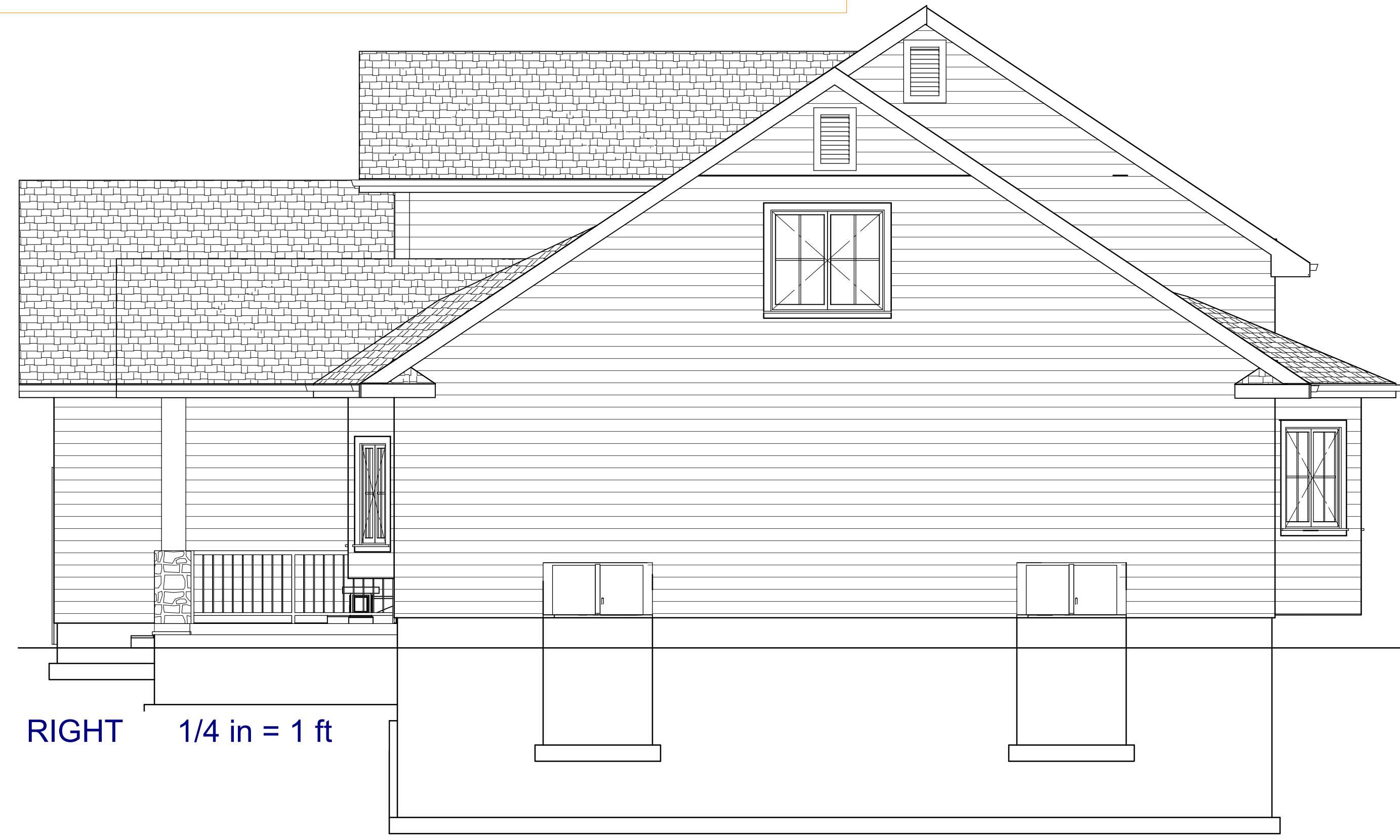
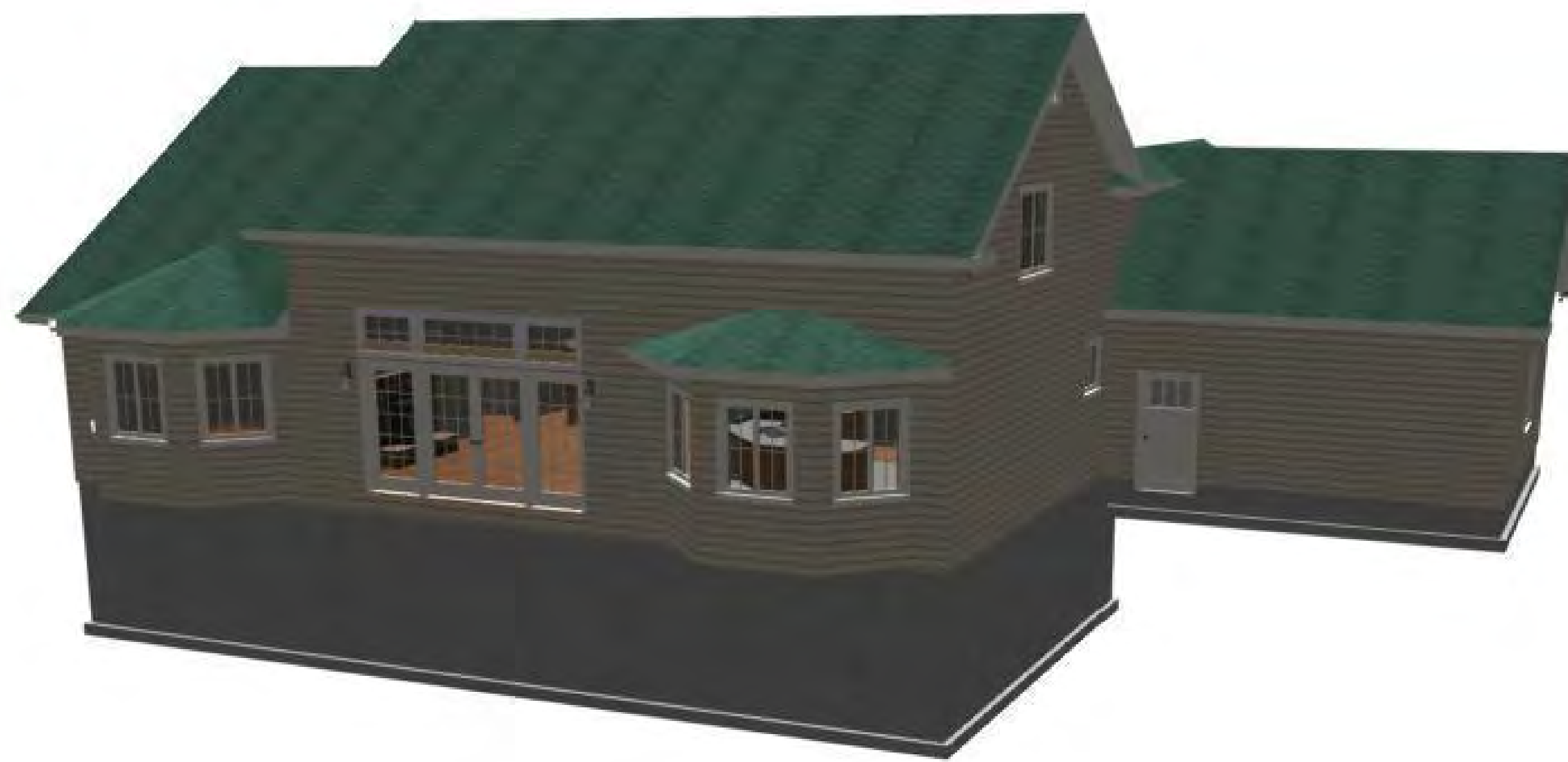

IMPORTANT: To the best of my knowledge these plans are drawn to comply with owner's and/or builder's specifications. The CONTRACTOR shall verify all dimensions and attached drawings, and shall determine and/or verify any structural components (i.e. grade beams, piers, support beams, lumber spans, etc.) that are necessary. BILL LYON ENTERPRISES is not liable for errors once construction has begun. While every effort has been made in the preparation of this plan to avoid mistakes, the maker can not guarantee against human error. Also, **LIVING AREAS** calculations do NOT include **Closets, Storage (Garport), Stairs, Entry, Hall, Laundry, and Balcony** areas.

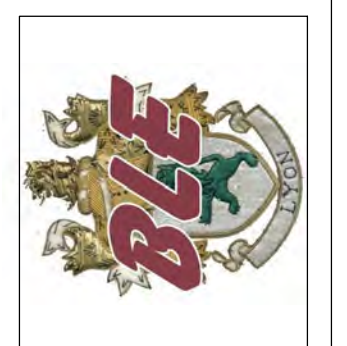

NO.	DESCRIPTION	BY	DATE

SHEET TITLE:
Elevations 2

Annis 24x36
 pricing example

DRAWINGS PROVIDED BY:
Bill Lyon Enterprises
 - blyon@billyon.com
 1385 HWY 305 N
 Olive Branch, MS 38654
 Phone: 662-893-3395 - Fax: 901-328-4747

Call Out Pg:

5/16/2011
 Dwgs 1/4" = 1'
 Details NTS

ARCH D (24" x 36")
 SHEET #:

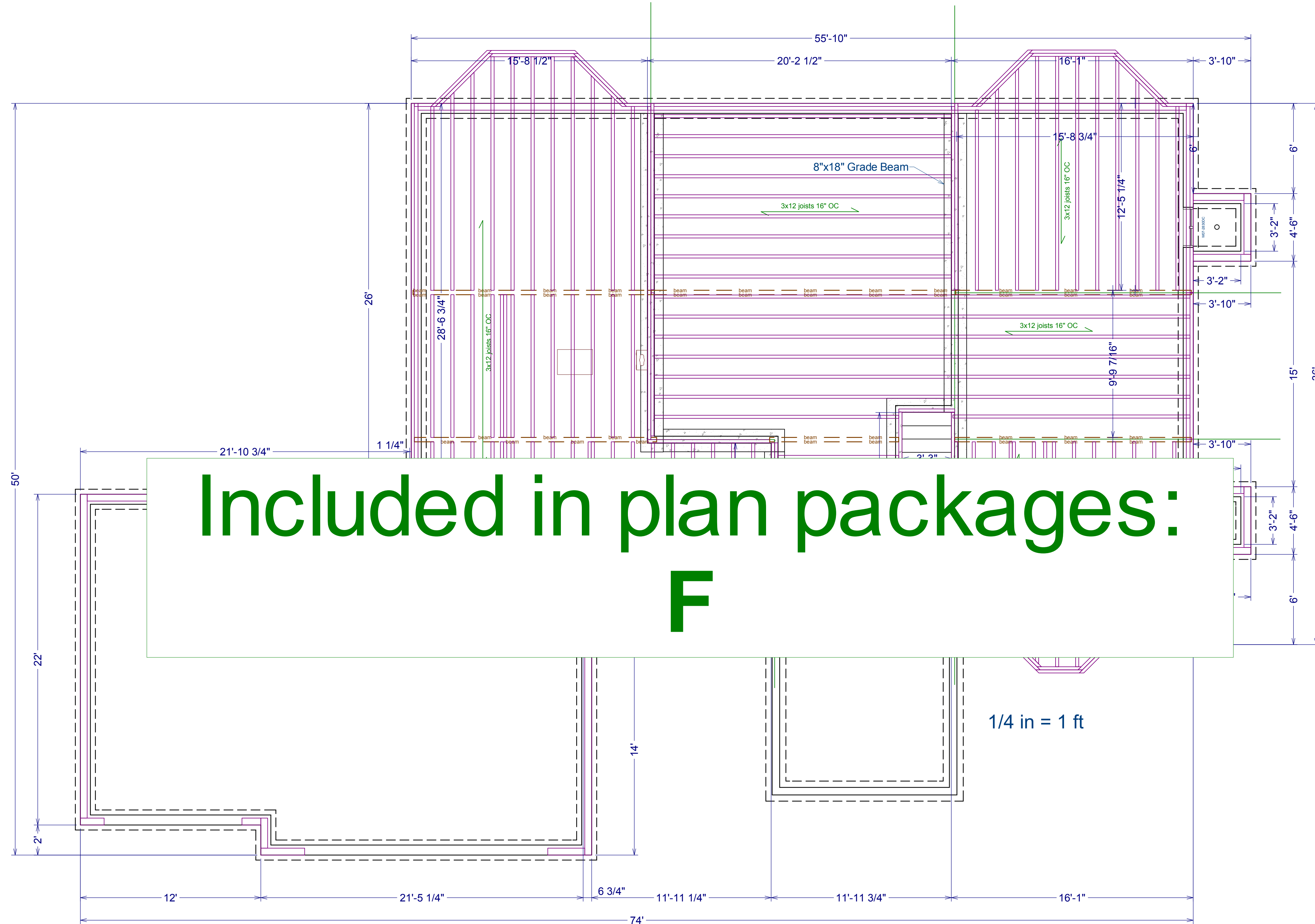

**CEILING JOIST LAYOUT
BASEMENT**

**Included in plan packages:
F**

IMPORTANT: To the best of my knowledge these plans are drawn to comply with owner's and/or builder's specifications. The CONTRACTOR shall verify all dimensions and attached drawings, and shall determine and/or verify any structural components (i.e. grade beams, piers, support beams, lumber spans, etc.) that are necessary. BILL LYON ENTERPRISES is not liable for errors once construction has begun. While every effort has been made in the preparation of this plan to avoid mistakes, the maker can not guarantee against human error. Also, **LIVING AREAS**, calculations do NOT include **Garage**, **Carport**, **Stair**, **Deck**, **Pool**, **Hot Tub**, **BBQ**, and **Backyard** areas.



NO.	DESCRIPTION	BY	DATE

SHEET TITLE:
**Framing
Basement**

**Annis 24x36
pricing example**

DRAWINGS PROVIDED BY:
Bill Lyon Enterprises
- blyon@billyon.com
1385 HWY 305 N
Olive Branch, MS 38654
Phone: 662-893-3395 - Fax: 901-328-4747

Call Out Pg:

5/16/2011
Dwgs 1/4" = 1'
Details NTS

ARCH D (24" x 36")
SHEET #:

6 of **14**



NO.	DESCRIPTION	BY	DATE

SHEET TITLE:
**Framing
Floor 1**

**Annis 24x36
pricing example**

DRAWINGS PROVIDED BY:
Bill Lyon Enterprises
- blyon@billyon.com
1385 HWY 305 N
Olive Branch, MS 38654
Phone: 662-893-3395 - Fax: 901-328-4747

Call Out Pg:

F1

5/16/2011

Dwgs 1/4" = 1'
Details NTS

ARCH D (24" x 36")

SHEET #:

7 of **14**

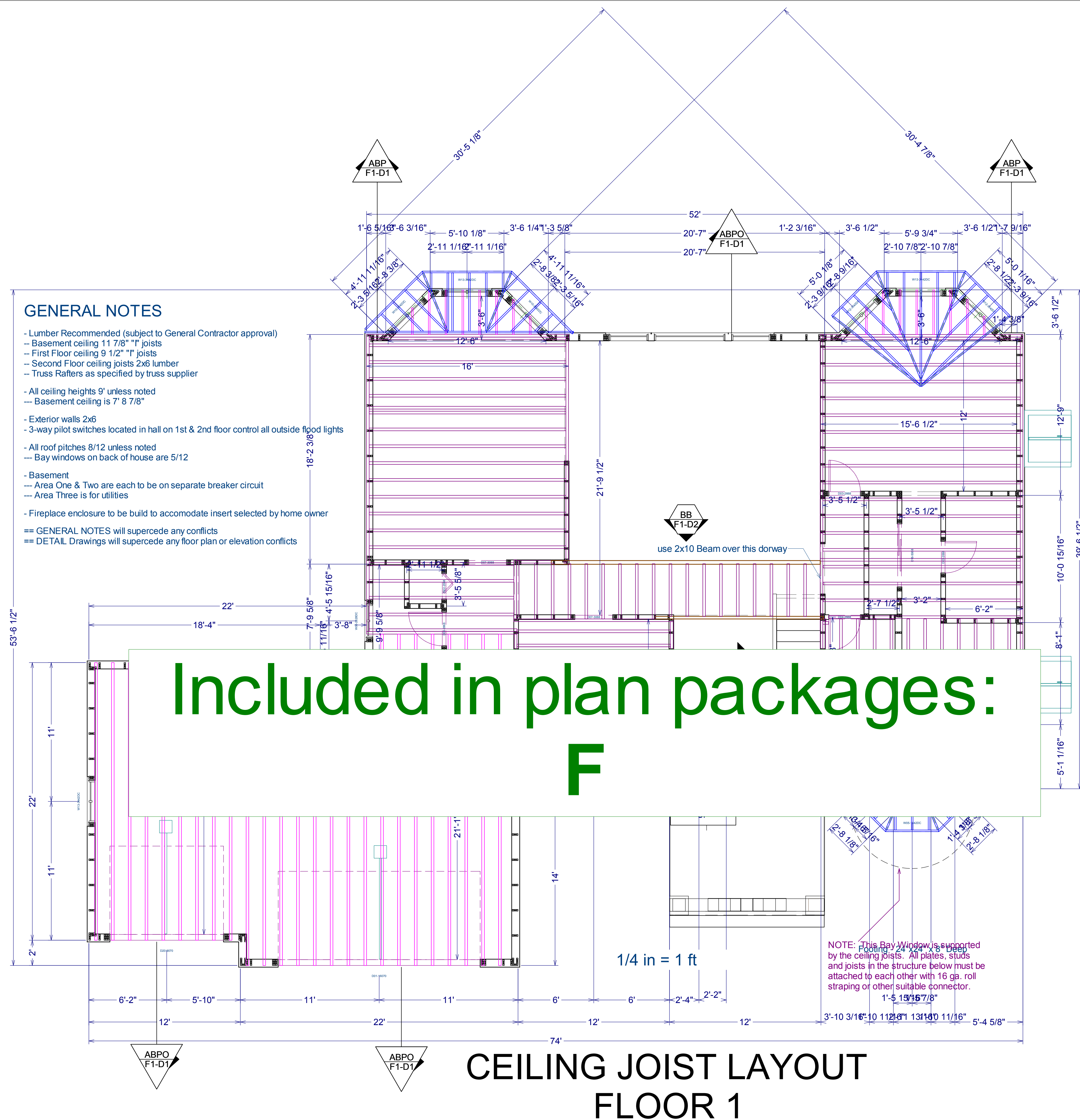

IMPORTANT: To the best of my knowledge these plans are drawn to comply with owner's and/or builder's specifications. The CONTRACTOR shall verify all dimensions and attached drawings, and shall determine and/or verify any structural components (i.e. grade beams, piers, support beams, lumber spans, etc.) that are necessary. BILL LYON ENTERPRISES is not liable for errors once construction has begun. While every effort has been made in the preparation of this plan to avoid mistakes, the maker can not guarantee against human error. Also, **LIVING AREAS** calculations do NOT include **Garage**, **Carport**, **Stair**, **Deck**, **Pool**, **Hot Tub**, **Deck**, and **Backyard** areas.

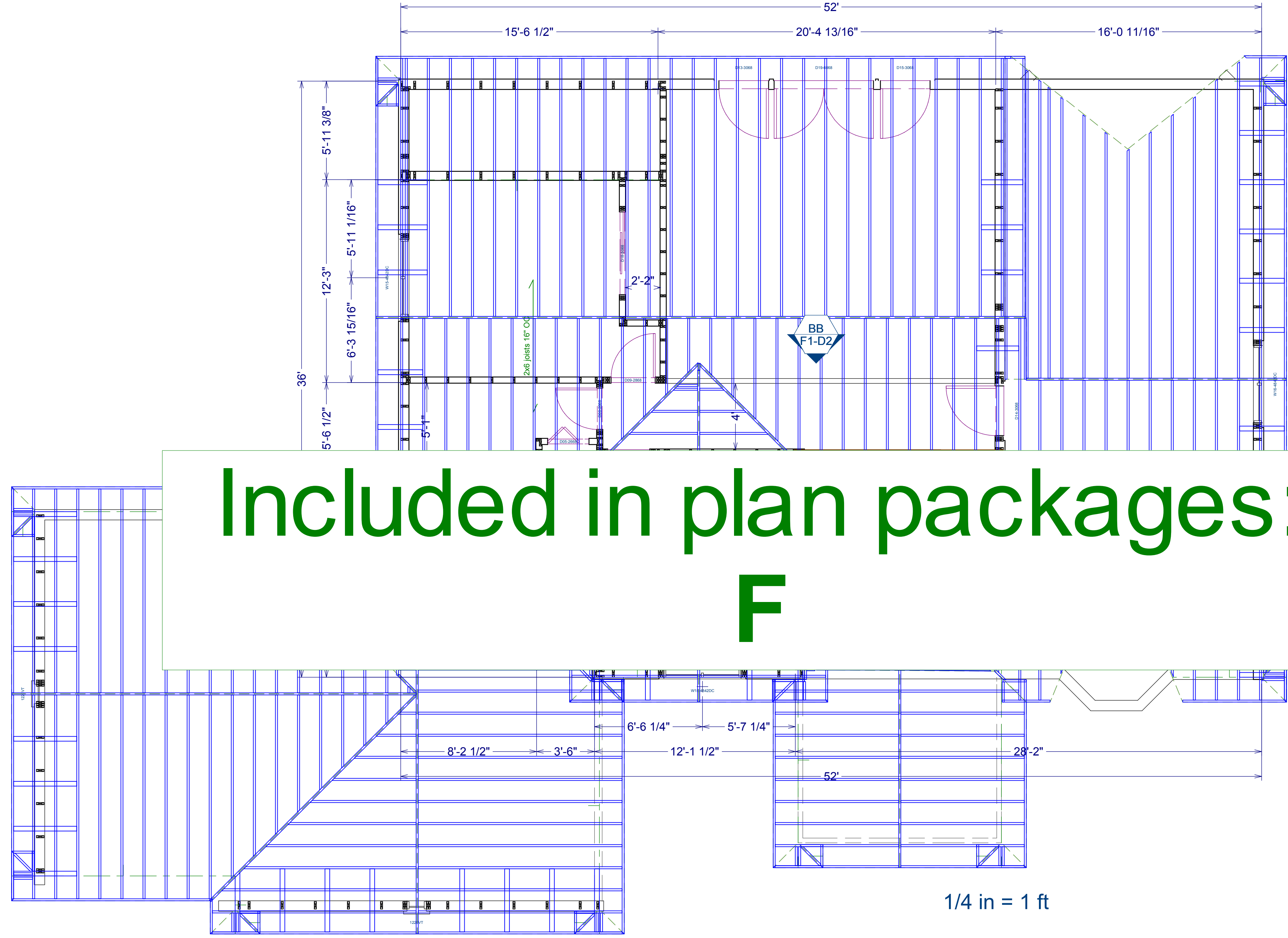

RAFTER LAYOUT

IMPORTANT: To the best of my knowledge these plans are drawn to comply with owner's and/or builder's specifications. The CONTRACTOR shall verify all dimensions and attached drawings, and shall determine and/or verify any structural components (i.e. grade beams, piers, support beams, lumber spans, etc.) that are necessary. BILL LYON ENTERPRISES is not liable for errors once construction has begun. While every effort has been made in the preparation of this plan to avoid mistakes, the maker can not guarantee against human error. Also, **LIVING AREAS**, calculations do NOT include **Garage**, **Carport**, **Stair**, **Deck**, **Pool**, **Deck**, and **Backyard** areas.



NO.	DESCRIPTION	BY	DATE

SHEET TITLE:
**Framing
 Rafters**

**Annis 24x36
 pricing example**

DRAWINGS PROVIDED BY:
Bill Lyon Enterprises
 - blyon@billyon.com
 1385 HWY 305 N
 Olive Branch, MS 38654
 Phone: 662-893-3395 - Fax: 901-328-4747

Call Out Pg:

5/16/2011
 Dwgs 1/4" = 1'
 Details NTS

ARCH D (24" x 36")
 SHEET #:

9 of **14**



DATE

BY

DESCRIPTION

NO.

Electrical Floor 1

Annis 24x36 pricing example

Bill Lyon Enterprises
- blyon@billyon.com
1385 HWY 305 N
Olive Branch, MS 38654
Phone: 662-893-3395 - Fax: 901-328-4747

Call Out Pg:

5/16/2011

Dwgs 1/4" = 1'

Details NTS

ARCH D (24" x 36")

SHEET #:

11 of 14

GENERAL NOTES

- Lumber Recommended (subject to General Contractor approval)
- Basement ceiling 11 7/8" "I" joists
- First Floor ceiling 9 1/2" "I" joists
- Second Floor ceiling joists 2x6 lumber
- Truss Rafters as specified by truss supplier

- All ceiling heights 9' unless noted
- Basement ceiling is 7' 8 7/8"

- Exterior walls 2x6
- 3-way pilot switches located in hall on 1st & 2nd floor control all outside flood lights

- All roof pitches 8/12 unless noted
- Bay windows on back of house are 5/12

- Basement
- Area One & Two are each to be on separate breaker circuit
- Area Three is for utilities

- Fireplace enclosure to be build to accomodate insert selected by home owner

== GENERAL NOTES will supercede any conflicts

== DETAIL Drawings w

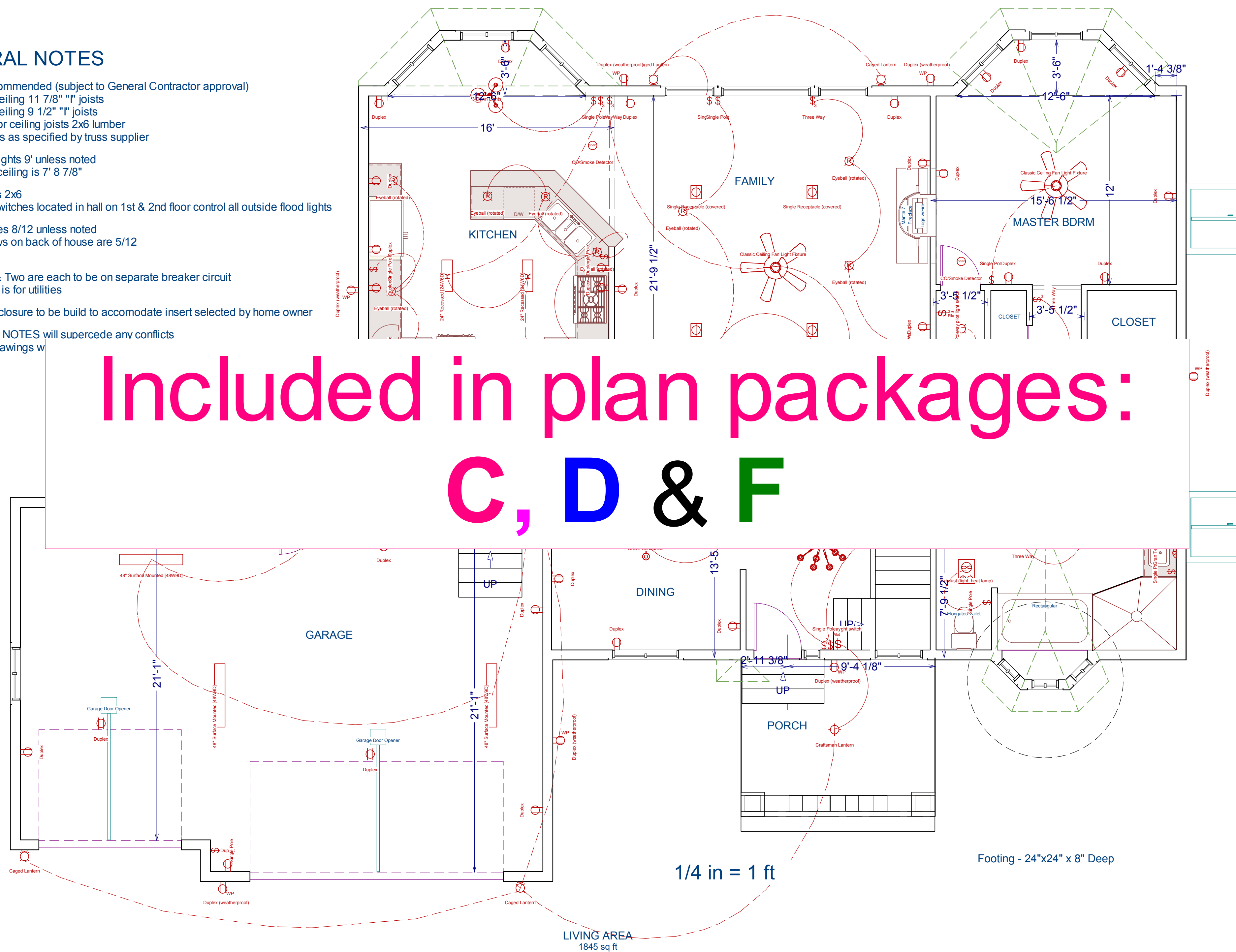

Included in plan packages: C, D & F

IMPORTANT: To the best of my knowledge these plans are drawn to comply with owner's and/or builder's specifications. The CONTRACTOR shall verify all dimensions and attached drawings, and shall determine and/or verify any structural components (i.e. grade beams, piers, support beams, lumber spans, etc.) that are necessary. BILL LYON ENTERPRISES is not liable for errors once construction has begun. While every effort has been made in the preparation of this plan to avoid mistakes, the maker can not guarantee against human error. Also, **LIVING AREA** calculations do NOT include Closets, Stairs, Corridors, Balcony, Garage (Carport), SIB, Entry, Attic, Laundry, and Bathroom areas.

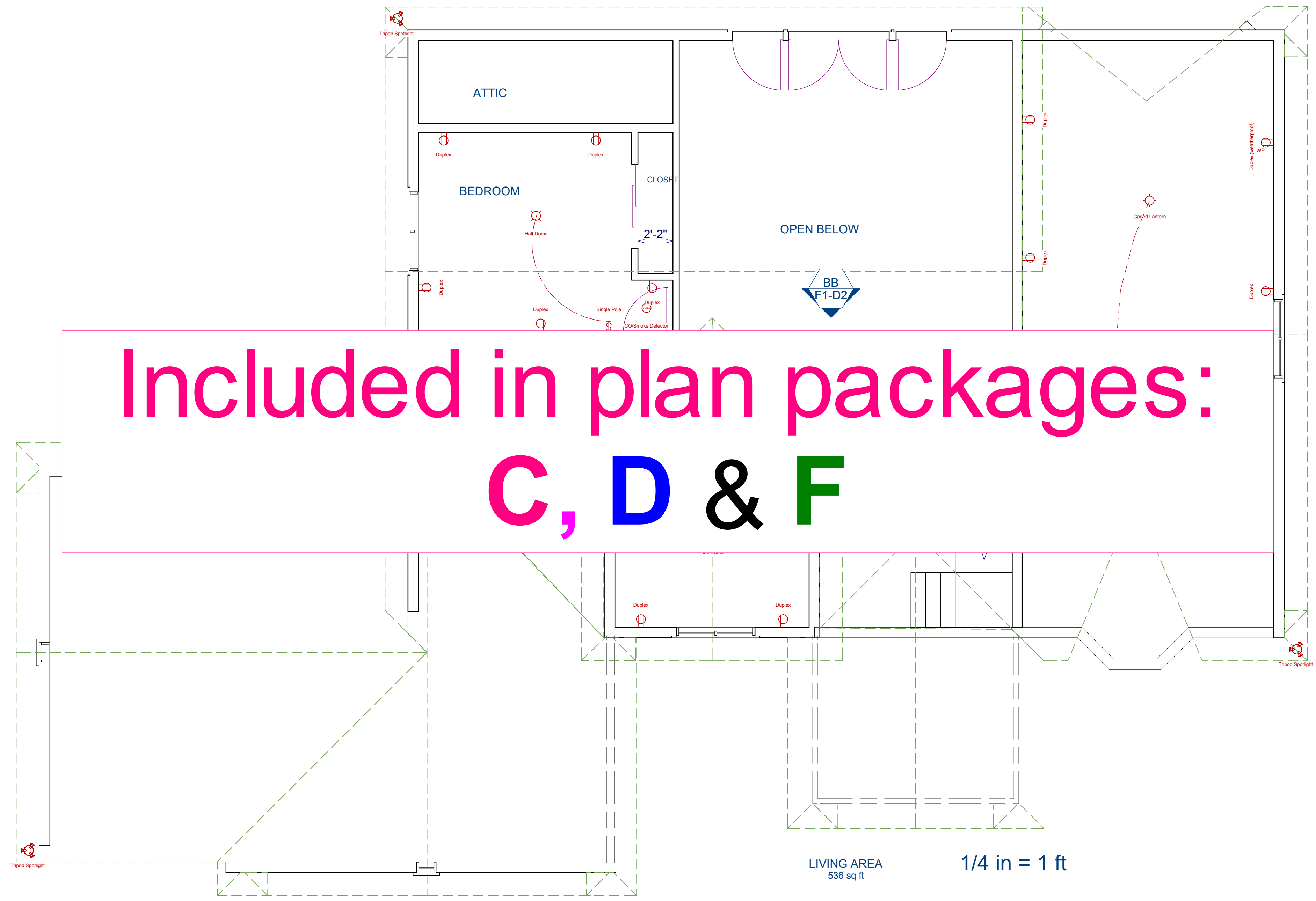

Included in plan packages:
C, D & F

IMPORTANT! To the best of my knowledge these plans are drawn to comply with owner's and/or builder's specifications. The CONTRACTOR shall verify all dimensions and attached drawings, and shall determine and/or verify any structural components (i.e. grade beams, piers, support beams, lumber spans, etc.) that are necessary. BILL LYON ENTERPRISES is not liable for errors once construction has begun. While every effort has been made in the preparation of this plan to avoid mistakes, the maker can not guarantee against human error. Also, **LIVING AREA** calculations do NOT include **Garage**, **Carport**, **Stair**, **Deck**, **Pool**, **Deck**, **Deck**, and **Backyard** areas.



NO.	DESCRIPTION	BY	DATE

SHEET TITLE:
**Electrical
Floor 2**

**Annis 24x36
pricing example**

DRAWINGS PROVIDED BY:
Bill Lyon Enterprises
- blyon@billyon.com
1385 HWY 305 N
Olive Branch, MS 38654
Phone: 662-893-3395 - Fax: 901-328-4747

Call Out Pg:

5/16/2011
Dwgs 1/4" = 1'
Details NTS

ARCH D (24" x 36")
SHEET #:

12 of **14**

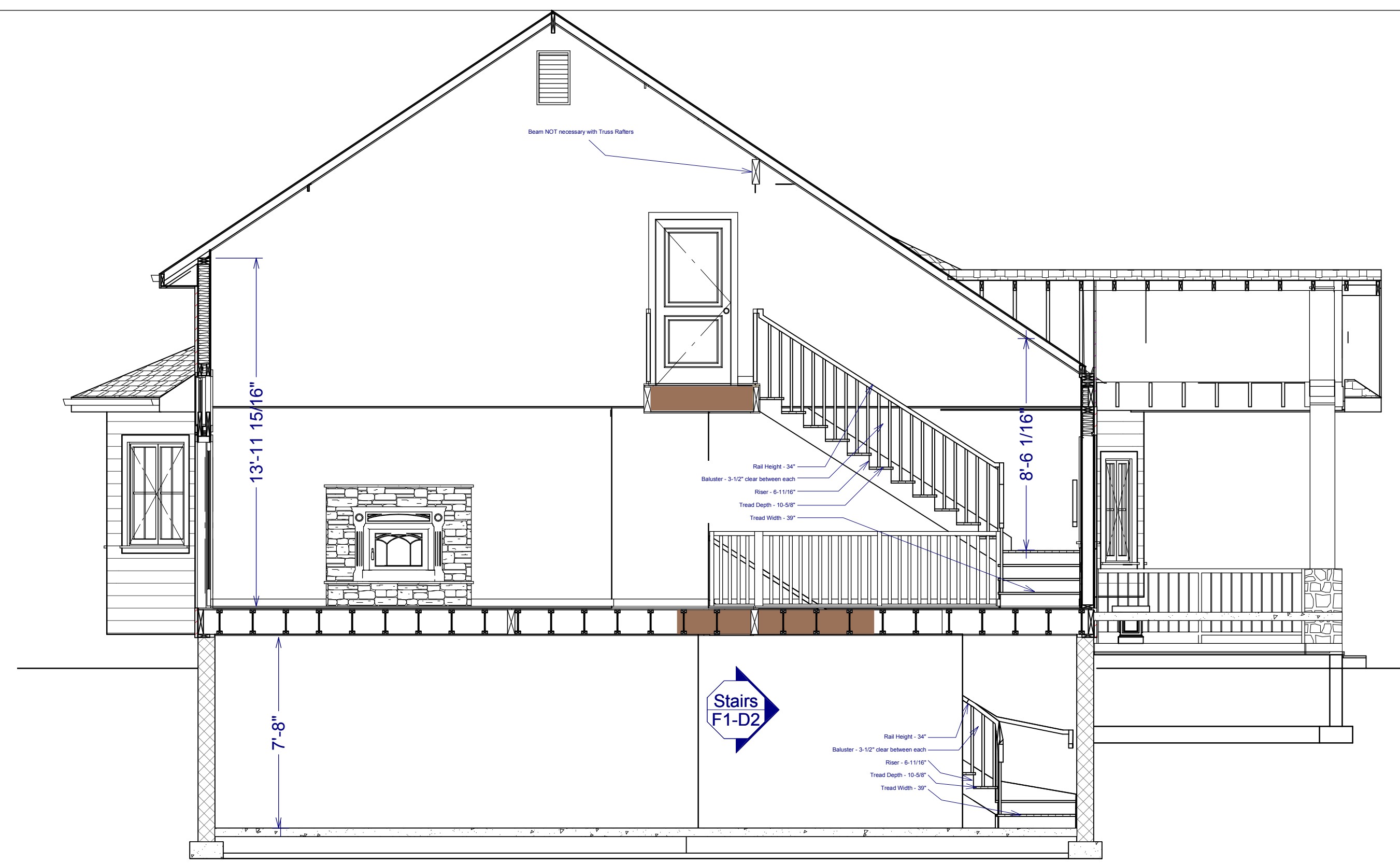

1/4 in = 1 ft

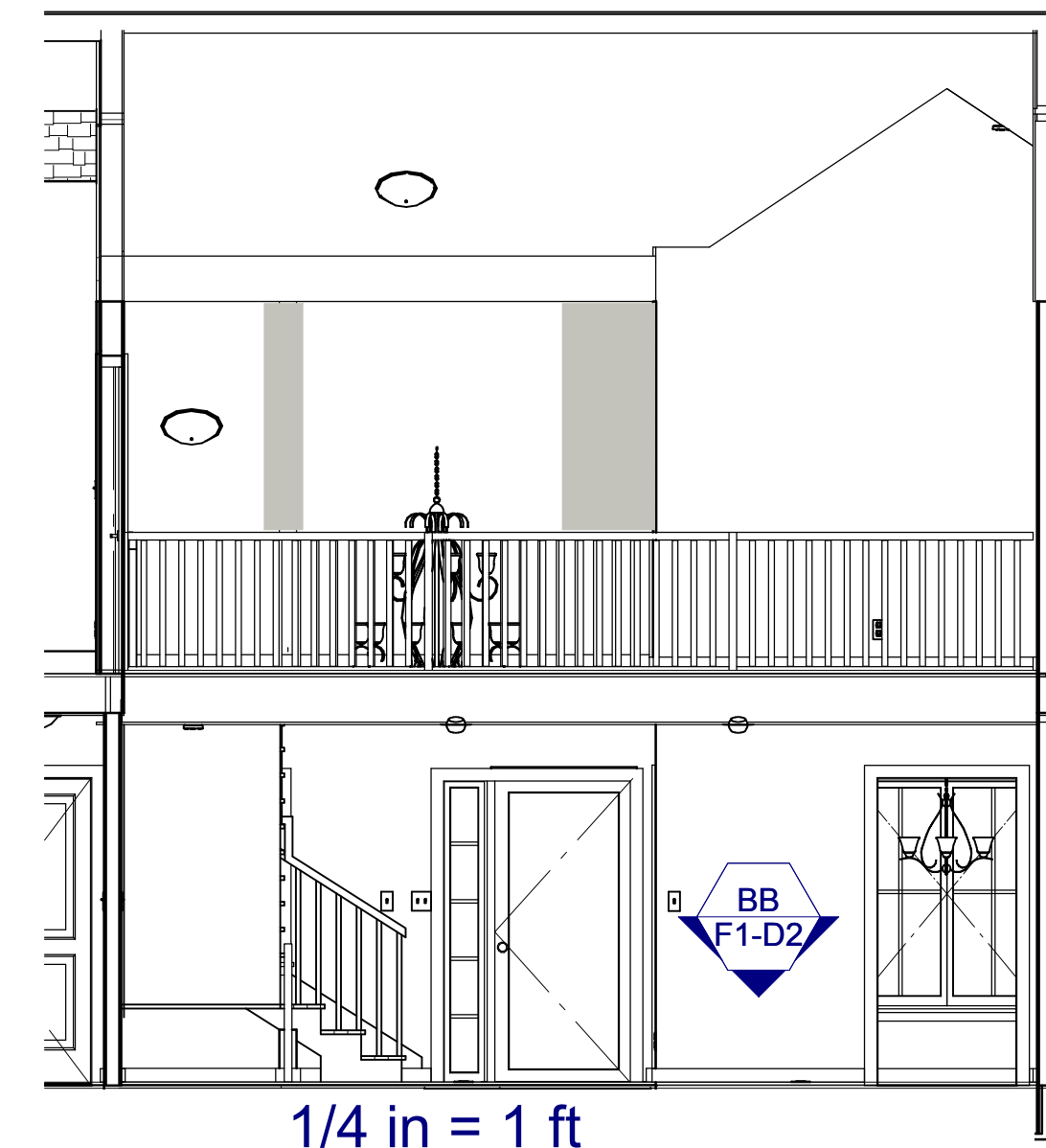

1/4 in = 1 ft

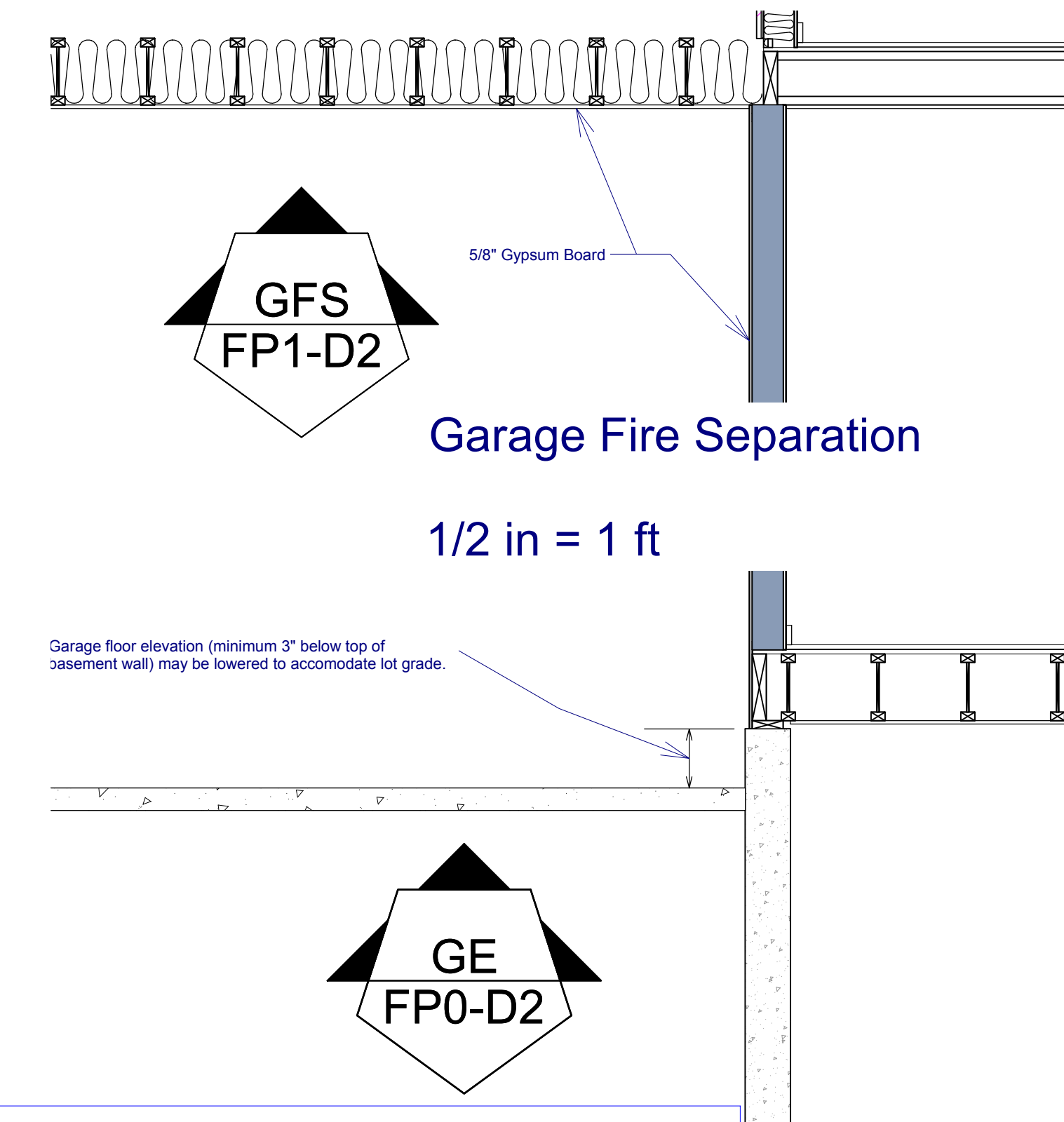

Garage Fire Separation

1/2 in = 1 ft

Included in plan packages:
D & F

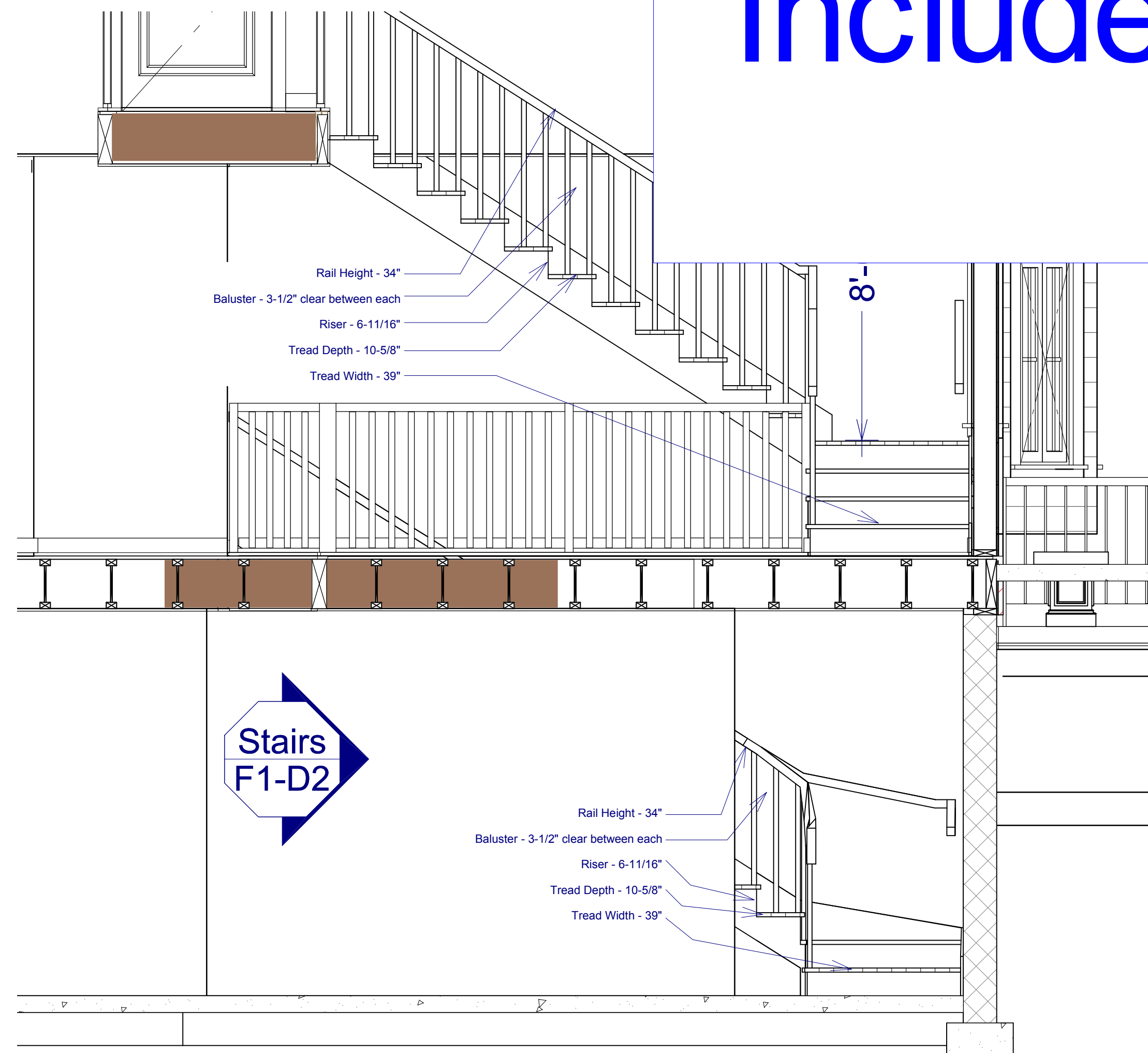

1/2 in = 1 ft

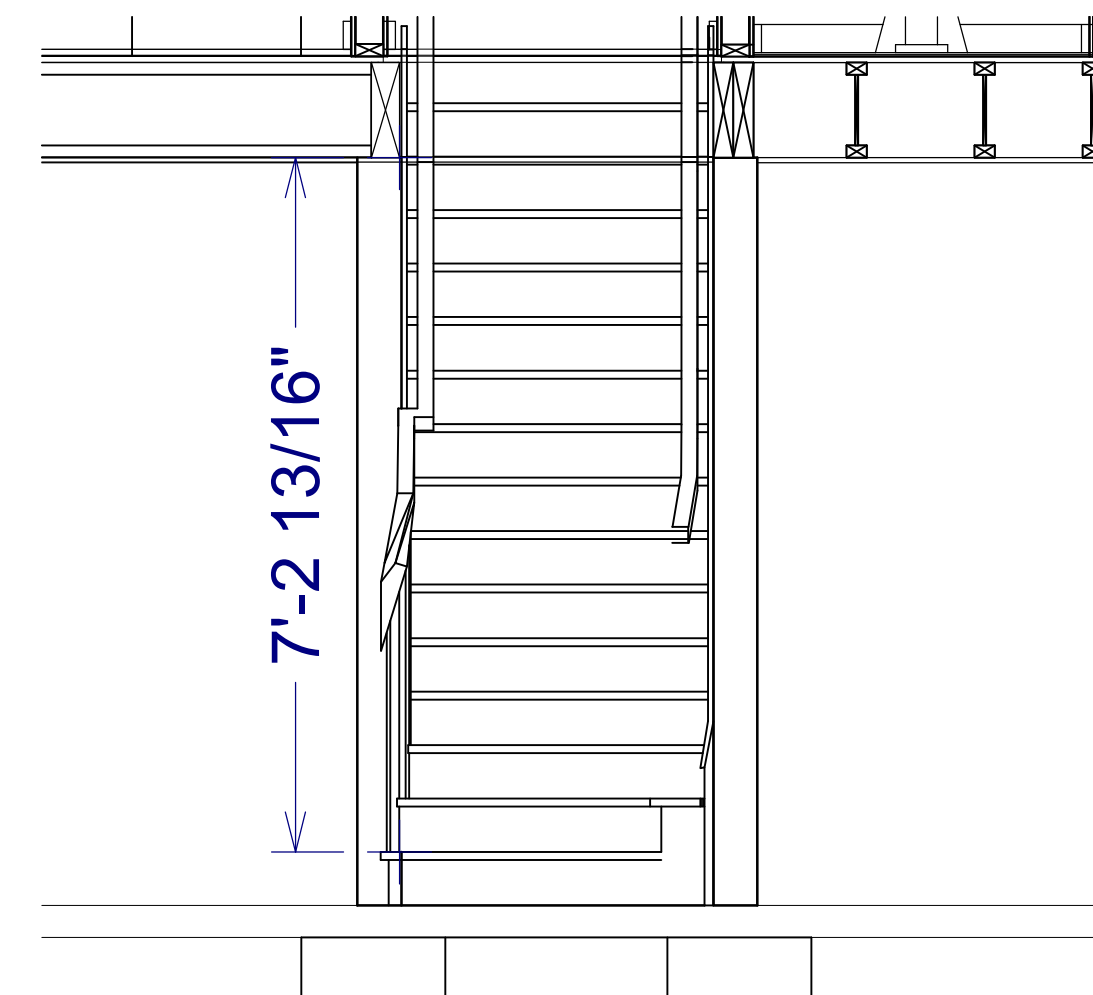

Basement Stairs Headroom

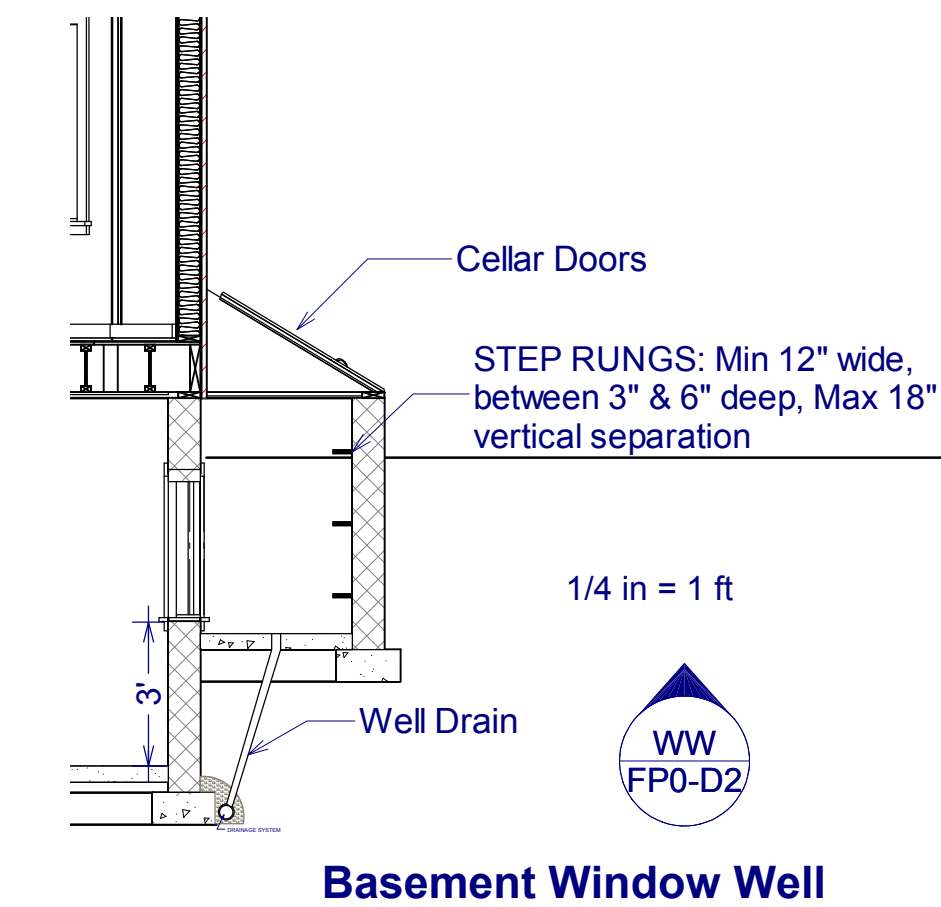

Basement Window Well

IMPORTANT: To the best of my knowledge these plans are drawn to comply with owner's and/or builder's specifications. The CONTRACTOR shall verify all dimensions and attached drawings, and shall determine and/or verify any structural components (i.e. grade beams, piers, support beams, lumber spans, etc.) that are necessary. BILL LYON ENTERPRISES is not liable for errors once construction has begun. While every effort has been made in the preparation of this plan to avoid mistakes, the maker can not guarantee against human error. Also, **LIVING AREAS** calculations do NOT include **Cellar/Basement**, **Garage**, **Carport**, **Stair**, **Entry**, **Attic**, **Loft**, **Deck**, and **Balcony** areas.

NO.	DESCRIPTION
BY	DATE
SHEET TITLE: Detail 2	
Annis 24x36 pricing example	
DRAWINGS PROVIDED BY: Bill Lyon Enterprises - bilyon@billyon.com 1385 HWY 305 N Olive Branch, MS 38654 Phone: 662-893-3395 - Fax: 901-328-4747	
Call Out Pg: D2	
5/16/2011	
Dwgs 1/4" = 1' Details NTS	
ARCH D (24" x 36")	
SHEET #:	
14 of 14	